

Platinum Electronic Fluid Pumps

Tempest Platinum Electronic Fluid Pumps
from the brand you trust for quality and innovation



TEMPEST excellence

visit www.tempestplus.com for most recent installation eligibility

Tempest® Part Number	Facet Part Number	OEM Part Number	Pump Description	Volts	PSI	Airframe Eligibility
Beechcraft						
A76284	476284	476439 or 58-920054-11	FUEL PUMP, HEATER	28	6-8	95-55, 95-A55, 95-B55, 95-C55, D55, E55, B95, B95A, D95A, E95, E55, 56TC, A56TC, 58, 58P, 58TC, G58, 60, A60, B60
A76284	476284	476439, 478587, 58-920054-5 or 58-920054-11	PUMP, ALCOHOL/ANTI-ICE	28	6-8	95, B95, B95A, 95-55, 95-A55, 95-B55, 95-B55A, D95A, E95, D55, D55A, E55, 58, G58, A65, 65-B80, 70, E18S, G18S and H18
A76284	476284	476439 or 58-920054-11	PUMP, FUEL RETURN	28	6-8	76 (ME-183 AFTER), 99, 99A, A99A, B99, 100, A100, 200, 200C and 200T
A76284	476284	476439 or 58-920054-11	FUEL PUMP, AUX ENGINE	28	6-8	C90, C90A, C90GT, E90, F90, and C99
A76411	476411	58-920054-9	FUEL PUMP, AUX ENGINE	28	4-5	95, B95, B95A and D95A
A80591	480591	477983 and 58-920054-3	FUEL PUMP, AUX ENGINE	14	5-6	B19, 76 and C23 (up to M-2178)
Cessna						
A76284	476284	C291506-0101, 9910088-3 or 9910004-3, -12	FUEL PUMP, HEATER	28	6-8	310P, 310Q, 320, 340, 414, 421 and 421B
A76284	476284	C291506-0101, 9910088-3 or 9910004-3, -12	FUEL PUMP, TIP TANK	28	6-8	401, 402 and 414
A76411	476411	5118721-1, 6508091-1 or 6508092-1, -4	FUEL PUMP, HEATER	28	4-5	335
A76411	476411	5118721-1, 6508091-1 or 6508092-1, -4	FUEL PUMP, TIP TANK	28	4-5	310Q, 310R, 340, 401, 402, 402B and 414
A76411	476411	5118721-1, 6508091-1 or 6508092-1, -4	PUMP, ALCOHOL/ANTI-ICE	28	4-5	335, 402, 404, 421, 425, 441, 500, 501, 525, 550, S550, 560 and 650
A80564*	480564	480563	FUEL PUMP, AUX ENGINE	28	4-5	152, A152, F152, FA152, 172N, 172P, 172Q, 310K, 310L, 310N, 310P, 310Q, 310R, T310P, T310Q, T310R, 320D, 320E, 320F, 340, 340A, 401, 401A, 401B, 402, 402A, 402B, 411, 411A, 414, 421, 421A, 421B or 421C
All A80564 pumps must use the appropriate Griggs STC. They can be found on PMA #PQ1206CE.						
American General (Grumman)						
A76411	476411	n/a	FUEL PUMP, AUX ENGINE	28	4-5	AG-5B
A78360	478360	TAES2100-3 401126-1	FUEL PUMP, AUX ENGINE	14	4-5.5	AA-1, AA-1A, AA-1B, AA-1C AA-5, AA-5A, AA5-B, AG-5B

Tempest® Part Number	Facet Part Number	OEM Part Number	Pump Description	Volts	PSI	Airframe Eligibility
Piper Aircraft						
A76088	476088	62220-004, 481-678	FUEL PUMP, AUX ENGINE	28	4-5.5	PA-23, PA23-160, PA-23-235, PA-E23-250, PA-23-250 (Navy UO-1)
A76088	476088	461-740, 622204-004	FUEL PUMP, AUX ENGINE	28	4-5.5	PA-28-140, PA-28-150, PA-28-151, PA-28-160, PA-28-161, PA-28-181
A78360	478360	35328-800, 481-666	FUEL PUMP, AUX ENGINE	14	4-5.5	PA-23, PA-23-160, PA-23-235, PA-E23-250, PA-23-250 (Navy UO-1)
A78360	478360	481-666	FUEL PUMP, AUX ENGINE	14	4-5.5	PA-24-250, PA-24-260, PA-25-235 and PA-25-260
A78360	478360	481-666	FUEL PUMP, AUX ENGINE	14	4-5.5	PA-28-140, PA-28-150, PA-28-151, PA-28-160, PA-28-161, PA-28-181
A78360	478360	481-666	FUEL PUMP, AUX ENGINE	14	4-5.5	PA-38-112
A80543	480543	481-701	FUEL PUMP, AUX ENGINE (Male Fitting)	14	6.5-8	PA-28-236, PA-28-235
A80543	480543	481-701	FUEL PUMP, AUX ENGINE	14	6.5-8	PA-32-260 and PA-44-180
A80543	480543	481-701, 481-842	FUEL PUMP, HEATER	14	6.5-8	PA-44-180 and PA-44-180T
A80563	480563	481-726	FUEL PUMP, HEATER	28	6-8	PA-31, PA-31-300, PA-31-325 and PA-31-350
A80564*	480564	---	FUEL PUMP, AUX ENGINE	28	4-5	PA-31, PA-31-325, PA-31-350 and PA-34-220T
A81842	481842	40007	FUEL PUMP, HEATER	14	6.5-8	PA-34-200T and PA-34-220T
Daher (Socata) (Morane Saulnier)						
A80543	480543	746-410, 480-543, 480-543E	FUEL PUMP, AUX ENGINE	14	6.5-8	MS 880B, MS 885, MS 893A, MS 894A, MS 892A-150, MS 892E-150, MS 893E, MS 894E
A80543	480543	746-410, 480-543, 480-543E	FUEL PUMP, AUX ENGINE	14	6.5-8	RALLYE 100S, RALLYE 150T, RALLYE 150ST, RALLYE 235E, RALLYE 235C
All A80564 pumps must use the appropriate Griggs STC. They can be found on PMA #PQ1206CE						
Tempest Electric Pumps are categorized as follows:						
With positive shut-off, fuel will not flow when the pump is off. A80563 and A80564						
Without positive shut-off, fuel can flow thru when the pump is off. A80543, A78360, A80591, A81842, A76088, A76411 and A76284. For example, these pumps would supply the head of fuel needed for the engine driven pump to continue to pull fuel from the source tank even when the pump has been shut off.						

Another quality product from the brands you trust.



Aero Accessories, LLC Platinum Fluid Pump Filter Change

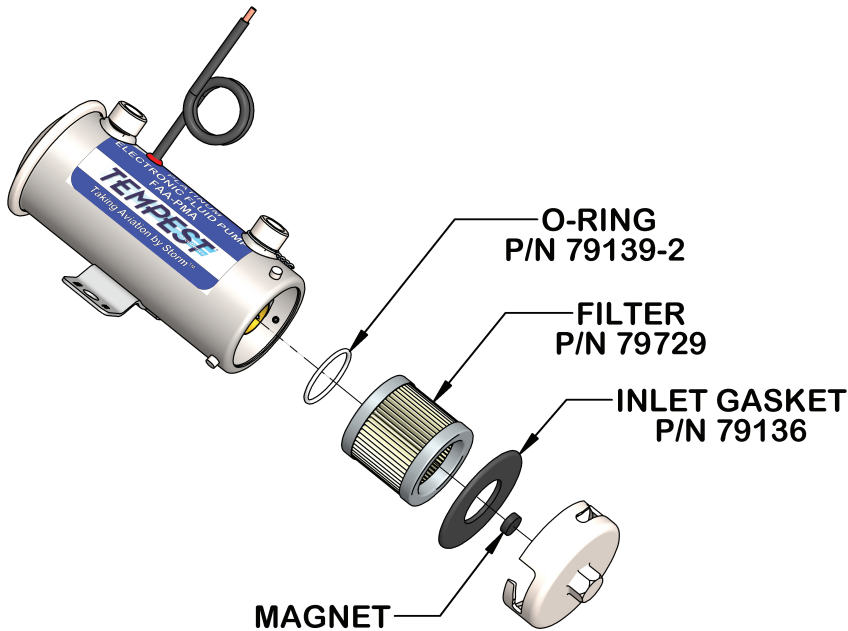

Filter Kit Part Number KIT-P1 (Universal - Fits all Aero Accessories Platinum Pumps)
Includes: Filter P/N 79729, Gasket P/N 79136 & O-Ring P/N 79139-2

Change the pump filter element when specified by the aircraft maintenance manual or when the pump output/pressure diminishes (an event that may indicate a dirty clogged filter). To change the filter: Remove the safety wire securing the removeable cap. Using an appropriate wrench, remove the cap (some fluid may run out depending on the mounting orientation of the pump). Remove the filter element, gasket, and O-ring.

There is a small magnet inside the removeable cap. Inspect it and clean it as necessary. It can be removed from the cap for cleaning. After cleaning, place it back in the center of the cap. Replace the O-ring. Replace the filter element. Replace the gasket in the removeable cap. Install the cap. Turn it until the three securing lugs are at the extreme (radiused) end of the slots in the cap. **DO NOT STOP SHORT.** Install the safety wire between the cap and the adjacent fitting. Operate the pump and check for leaks. Prior to approving the aircraft for return to service, correct any discrepancies found.

Use only Aero Accessories, LLC replacement filters with your Platinum pump. Filters supplied by other manufacturers will not properly fit Aero Accessories, LLC's Platinum pumps.



www.tempestaero.com

Copyright ©2024 Tempest Aero Group